

One-touch fittings---threaded type



Product feature

1. Variable models can be widely used in every kind of pneumatic systems.
2. High circulation performance bear the same flow with the volume of the tube innerdiameter.
3. The nickel plated body is anti-corrosion and anti-pollution, which allows a broader application.
4. Metal fittings can be used in high temperature environment.

Specification

Operating pressure range	0~9kgf/cm ² (0~0.9MPa)
Negative pressure	-750mmHg(10Torr)
Proof pressure	3MPa
Ambient and fluid temperature (°C)	0~150

Ordering code

BB 01 01			
Model		Thread type	
BB: Male connector		Blank: PT	
BD: Male & female connector		Thread connection II	
BU: Double female connector		01: 1/8"	
BZ: Hexagon head cap plug		02: 1/4"	
		03: 3/8"	
		04: 1/2"	
		Thread connection I	
		01: 1/8"	
		02: 1/4"	
		03: 3/8"	
		04: 1/2"	

Configuration table of tubing thread.

Product series	Thread connection I				Thread connection II			
	01	02	03	04	01	02	03	04
BB	01	●	●	●				
	02		●	●				●
	03			●				●
	04			●				●
BD	01		●	●				●
	02			●				●
	03							●
	04							●
BU	01	●						
	02		●					
	03			●				
	04							●

Product series	Thread connection			
	01	02	03	04
BZ	●	●	●	●

Dimensions

BB series

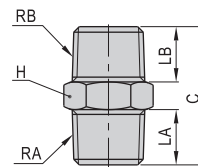

Model\Item	RA	RB	LA	LB	C	H(Across flat)
BB0101	1/8"	1/8"	7.5	7.5	19.5	10
BB0102	1/4"	1/8"	10	7.5	22.5	14
BB0103	3/8"	1/8"	11	7.5	24	17
BB0202	1/4"	1/4"	10	10	25	14
BB0203	3/8"	1/4"	11	10	26.5	17
BB0204	1/2"	1/4"	14	10	30	21
BB0303	3/8"	3/8"	11	11	27.5	17
BB0304	1/2"	3/8"	14	11	31	21
BB0404	1/2"	1/2"	14	14	34	21

BD series

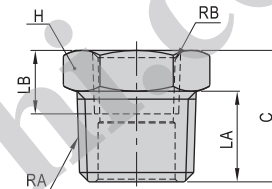

Model\Item	RA	RB	LA	LB	C	H(Across flat)
BD0102	1/4"	1/8"	10	8	14.5	14
BD0103	3/8"	1/8"	11	8	16	17
BD0104	1/2"	1/8"	14	8	19.5	21
BD0203	3/8"	1/4"	11	11	16	17
BD0204	1/2"	1/4"	14	11	19.5	21
BD0304	1/2"	3/8"	14	12	19.5	21

BU series

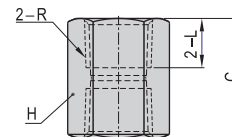

Model\Item	R	L	C	H(Across flat)
BU0101	1/8"	8	17	12
BU0202	1/4"	11	23	17
BU0303	3/8"	12	25	21
BU0404	1/2"	13.5	28	24

BZ series

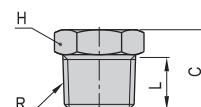

Model\Item	R	L	C	H(Across flat)
BZ01	1/8"	7.5	11	10
BZ02	1/4"	10	14.5	14
BZ03	3/8"	11	16	17
BZ04	1/2"	14	19.5	21



Tube fittings

One-touch fittings---threaded type



Product feature

1. Variable models can be widely used in every kind of pneumatic systems.
2. High circulation performance bear the same flow with the volume of the tube innerdiameter.
3. The nickel plated body is anti-corrosion and anti-pollution, which allows a broader application.
4. Metal fittings can be used in high temperature environments.

Specification

Operating pressure range	0~9kgf/cm ² (0~0.9MPa)
Negative pressure	-750mmHg(10Torr)
Proof pressure	3MPa
Ambient and fluid temperature (°C)	0~150

Note: The temperature resistance level of the tubing should be confirmed first when used in high temperature environments.

Ordering code

BKC 06 04 - 01			
Model	Thread type	Thread connection	Tubing inner diameter
BKC: Straight locknut connector	Blank: PT	M3: M3X0.5	25: Φ2.5mm
		M5: M5X0.8	04: Φ4mm
		01: 1/8"	05: Φ5mm
		02: 1/4"	06: Φ6mm
		03: 3/8"	65: Φ6.5mm
		04: 1/2"	75: Φ7.5mm
			08: Φ8mm
			09: Φ9mm

Note: When using the tubing Φ8×Φ5.5, the straight lock nut connector of BKC0806can be used.

Configuration table of tubing and tubing thread

Product series	Tubing outer diameter	Tubing inner diameter	Thread connection			
			M3	M5	01	02
BKC	04	25	●	●	●	●
	06	04			●	●
	08	05			●	●
	06	06			●	●
	10	65			●	●
	75				●	●
	08				●	●
	09				●	●
					●	●
					●	●

Dimensions

BKC series

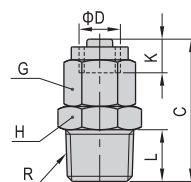

Model\Item	Tubing diameter ΦD	Tubing outer diameter	Tubing inner diameter	R	L	C	K	G(Across flat)	H(Across flat)
BKC0425-M3	4	2.5	M3×0.5	3	17				8
BKC0425-M5			M5×0.8	3.5	17.5	5		8	8
BKC0604-01			1/8"	7.5	20.5				10
BKC0604-01			1/8"	7.5	22				10
BKC0604-02	6	4	1/4"	10	25.5	5.5	10		14
BKC0604-03			3/8"	11	27				17
BKC0805-01			1/8"	7.5	24				12
BKC0805-02			1/4"	10	27.5				14
BKC0805-03			3/8"	11	29				17
BKC0806-01	8	5	1/8"	7.5	24	6.5	12		12
BKC0806-02			1/4"	10	27.5				14
BKC0806-03			3/8"	11	29				17
BKC1065-02			1/4"	10	30				15
BKC1065-03			3/8"	11	31.5				17
BKC1065-04	10	6.5	1/2"	14	35.5	7.5	15		21
BKC1075-02			1/4"	10	30				15
BKC1075-03			3/8"	11	31.5				17
BKC1075-04			1/2"	14	35.5				21
BKC1208-02			1/4"	10	30				17
BKC1208-03			3/8"	11	31.5				17
BKC1208-04			1/2"	14	35.5				21
BKC1209-02	12	8	1/4"	10	30	7.5	17		17
BKC1209-03			3/8"	11	31.5				17
BKC1209-04			1/2"	14	35.5				21

Installation and application

1. Method of inserting or removal a tubing

1.1 Inserting a tubing

Place the locking cap over the tubing, and insert the tubing into the body, then tighten the locking cap. (As figure 1)

1.2 Removing a tubing

Loosen the locking cap first, then remove the tubing. (As figure 2)

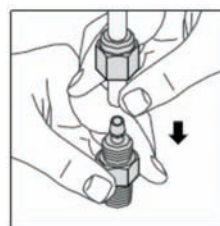

Figure 1

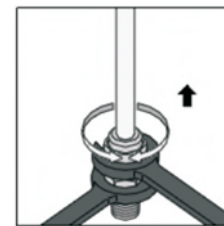

Figure 2

2. Method of tightening the connector thread

Tighten the connector with a hex wrench, as shown below.

